



15 Fullingdale Road

The Headlands, Northampton

oriordanbond



15 Fullingdale Road

The Headlands

Northampton NN3 2PZ

PRICE £227,500

An extended and improved semi detached property, situated in the popular Headlands area, close to Abington Park, Eastfield Park and many local schools.

The accommodation comprises entrance hall, cloakroom/WC, sitting room, fitted kitchen/dining room, three first floor bedrooms and a fitted family bathroom. Outside is a driveway to the front providing off road parking for two vehicles and a large landscaped southerly facing garden to the rear with feature artificial lawn. Further benefits include uPVC double glazing and gas radiator heating. (C/881/L)

Additional information

- Council Tax Band: C
- Energy Efficiency Rating: D

Viewing

Viewing strictly by appointment – details below

Disclaimer

O'Riordan Bond Estate Agents Limited has not tested apparatus, equipment, fittings or services and so cannot verify they are in working order. The buyer is advised to obtain verification from their solicitor or surveyor.

O'Riordan Bond Weston Favell Sales
01604 784007

westonfavell@oriordanbond.co.uk

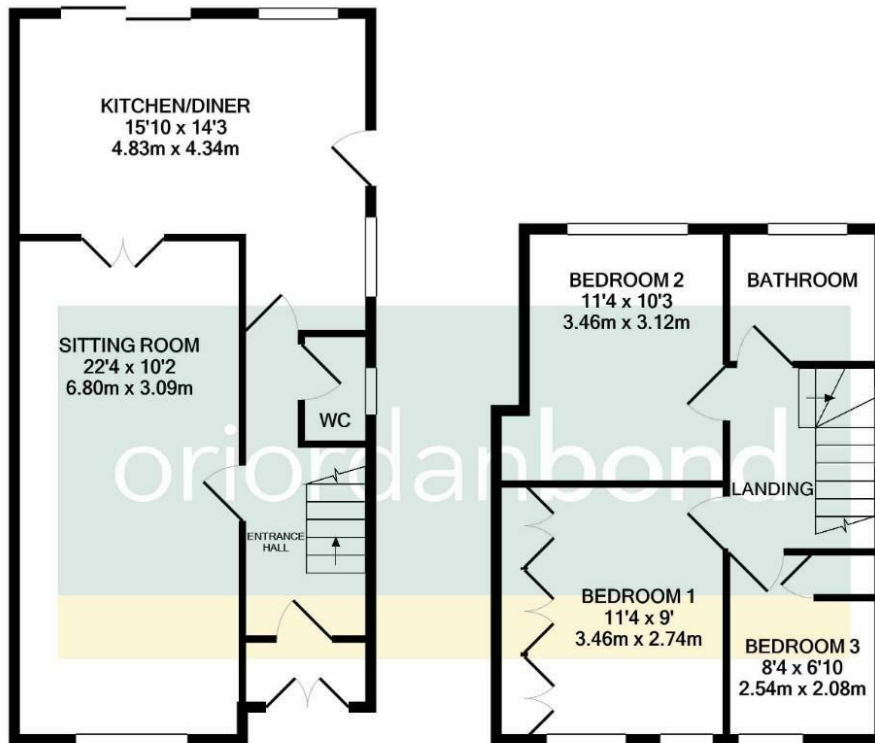

GROUND FLOOR
APPROX. FLOOR
AREA 503 SQ.FT.
(46.8 SQ.M.)

1ST FLOOR
APPROX. FLOOR
AREA 377 SQ.FT.
(35.0 SQ.M.)

TOTAL APPROX. FLOOR AREA 881 SQ.FT. (81.8 SQ.M.)

Whilst every attempt has been made to ensure the accuracy of the floor plan contained here, measurements of doors, windows, rooms and any other items are approximate and no responsibility is taken for any error, omission, or mis-statement. This plan is for illustrative purposes only and should be used as such by any prospective purchaser. The services, systems and appliances shown have not been tested and no guarantee as to their operability or efficiency can be given
Made with Metropix ©2021